

44-48" curved overhang, granite, 3cm. 120-121" wide. 44" at corners, 48" at center, 2-3" overhang from frame at front and sides

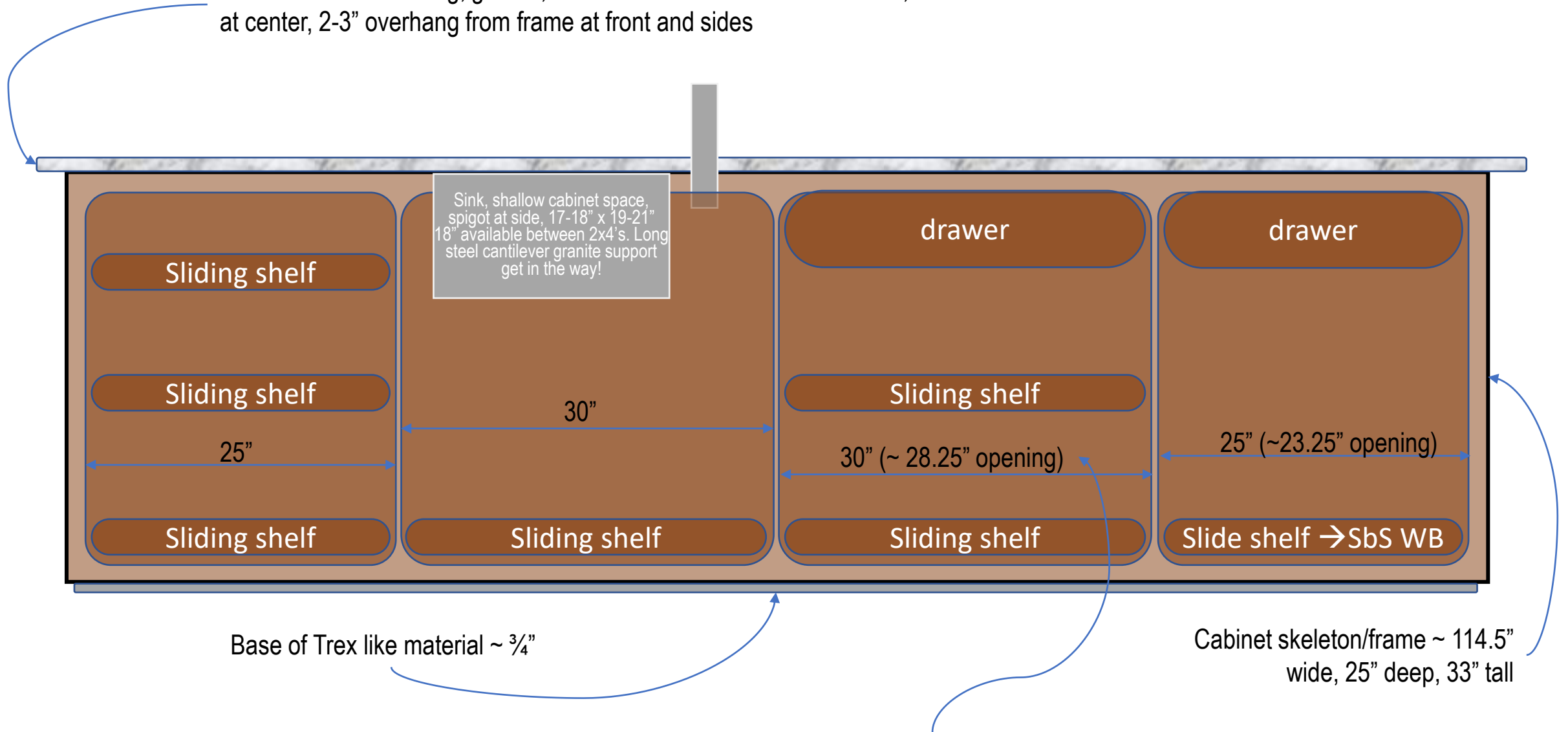

Frame dsgn has an opening = door - 1.5", exterior cladding to = 1.5" - 1.5" + as drawer slide mechanism may allow to maximize width of drawer (1/8" more one each side for a door-1.5-.0.25" width?

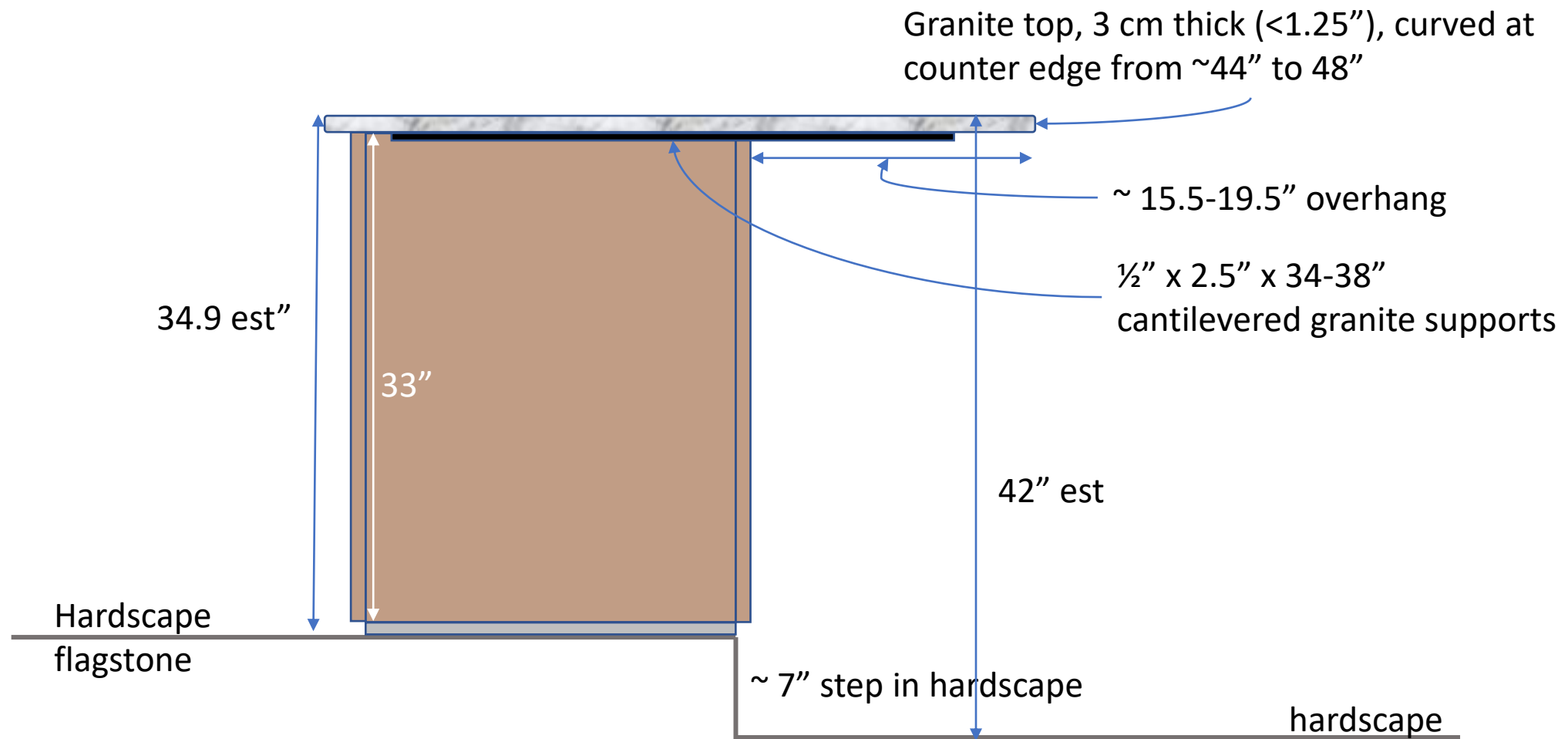

- Only one sink in cabinet, no cooking appliances. Cooking appliances on wheels.
- Exterior, sapele, natural oil finished (inside & out), ship lap, $7''$ face, horizontal, $\frac{3}{4}$ S4S + $2''$ & $3''$ vertical $1''$ (or $1.25''$) S4S at corners covering edges of ship lap horizontal boards. Longest board $\sim 112''$, elongated holes to allow movement needed?
- All screwed, no nails. No screw to show below $1.25''$ below granite.
- Storage space to be maximized. All on slide out shelves or drawers.
- Faucet may be to the side of the sink. 3 electrical outlets, 1 inside sink cabinet, 1 at each exterior side (flush)
- Muffin fan with humidistat control to air out interior needed?