



Approved by Martha Kennedy  
Via email April 15, 2015

## Cabinetry Info Sheet

**Today's Date:** April 10, 2015      **Job Name:** Menlo Oaks  
**To:** Martha and Raoul Kennedy      **Job Number:** 1216  
**From:** Mosaic Architects      **Sent via:** Email  
**CC:** Ted Horton

- 
- Room: **1-04 Sun Room**
  - Type of cabinet: Built-in bookshelves with backing
  - Cabinetry type: Casework
  
  - Cabinetry box: ¾" Plywood with ¼" plywood backing, formaldehyde free, paint grade, painted to match casework front
  - Cabinetry box visible interior: Painted to match casework front
  - Cabinetry box visible exterior: Painted to match casework front
  
  - Cabinetry front: Solid wood, no sharp corners, painted glossy white  
Cabinetmaker to provide sample
  - Cabinetry front types: N/A
  - Cabinetry doors: N/A
  - Cabinetry drawer body: N/A
  - Cabinetry drawer face: N/A
  
  - Cabinetry door hinges: N/A
  - Cabinetry drawer glides: N/A
  - Cabinetry inserts: None
  
  - Toe Kick: None
  
  - Cabinetry top: N/A
  - Cabinetry top cut outs: N/A
  - Cabinetry Pulls: None

Revision: April 15, 2015

Please contact the sender if there are any questions regarding this transcript.

M:\Prj\1216MenloOaks\1216Docs\1216Memo-CabSpecs-1-04-SunRoom.doc

Approved by Martha Kennedy  
Via email April 15, 2015

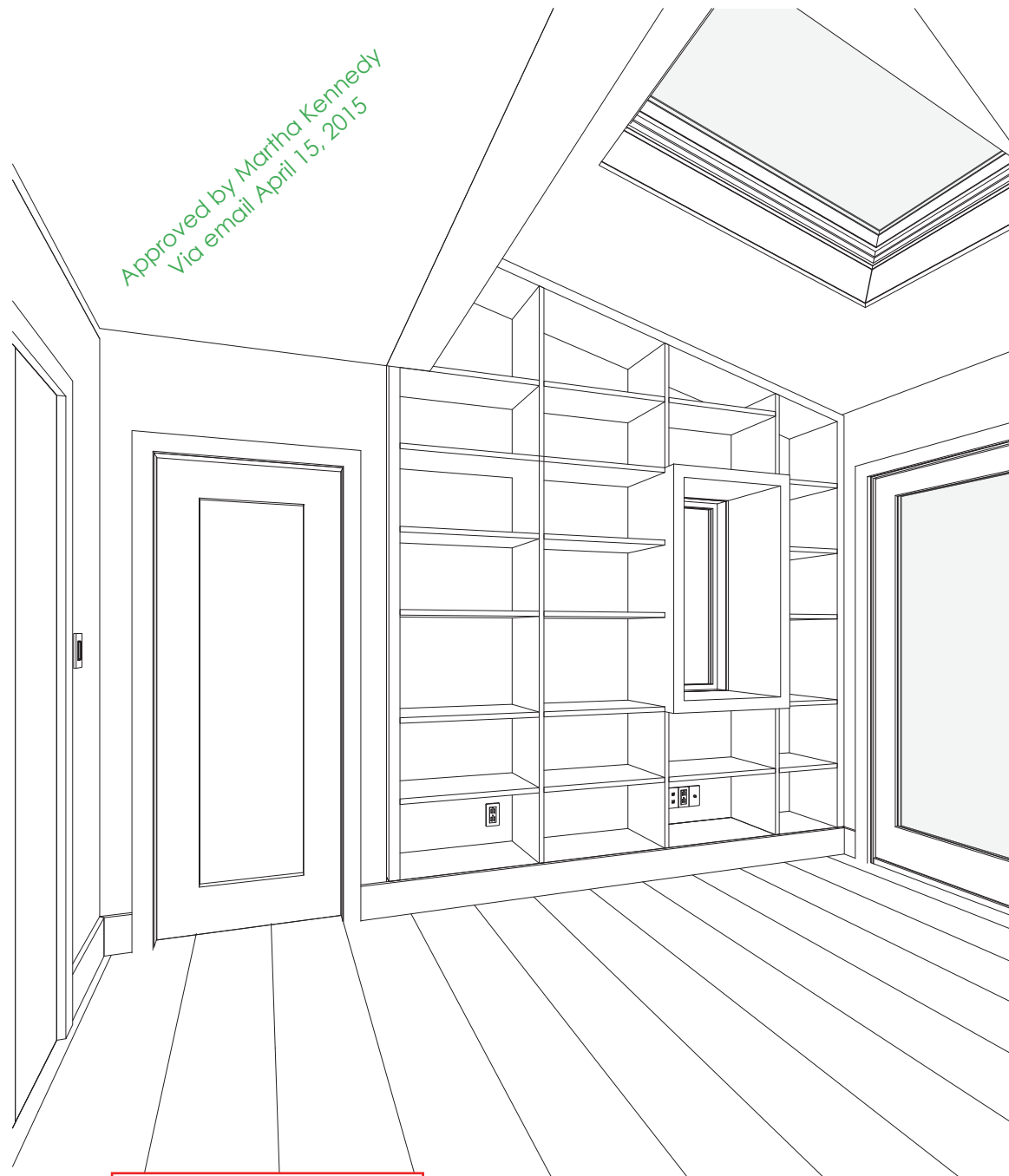

Revision: April 15, 2015

R

CABINERY PACKAGE - MAIN HOUSE - SUN ROOM

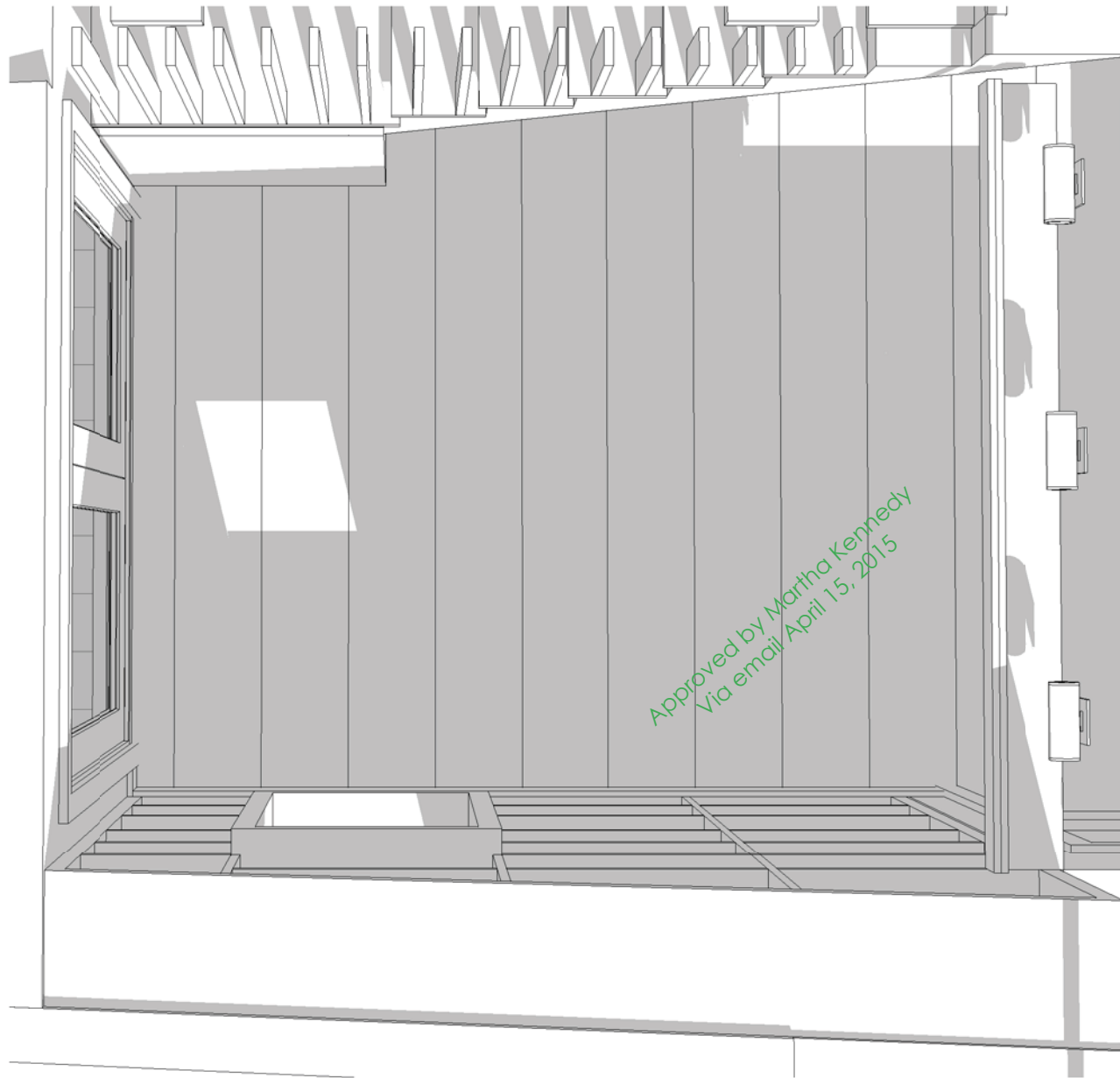

Revision: April 15, 2015

R

CABINETRY PACKAGE - MAIN HOUSE - SUN ROOM - 3D VIEW

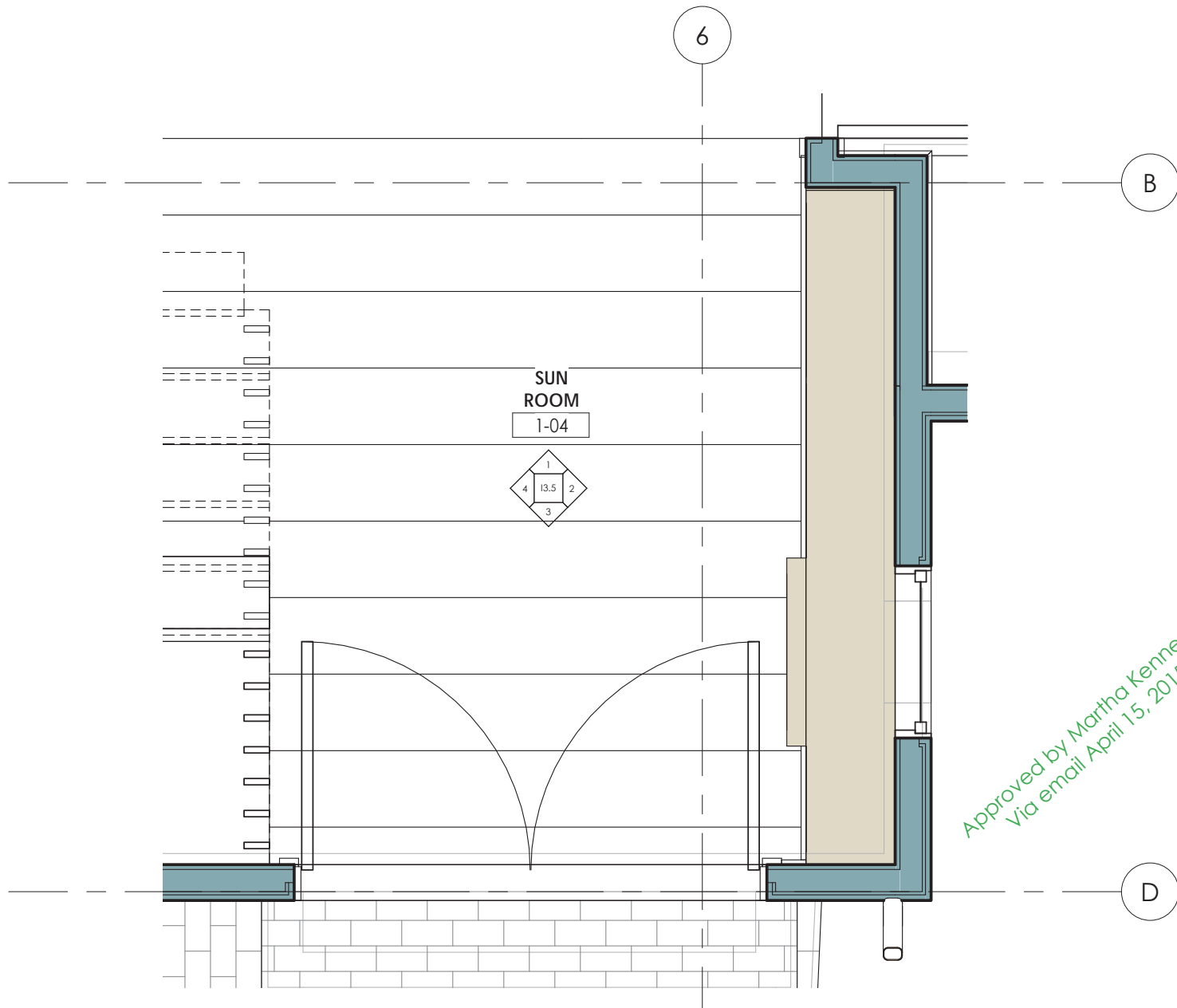

Approved by Martha Kennedy  
Via email April 15, 2015

Revision: April 15, 2015

FP

CABINERY PACKAGE - MAIN HOUSE - SUNROOM - FLOOR PLAN

1/2" = 1'-0"

Approved by Martha Kennedy  
Via email April 15, 2015

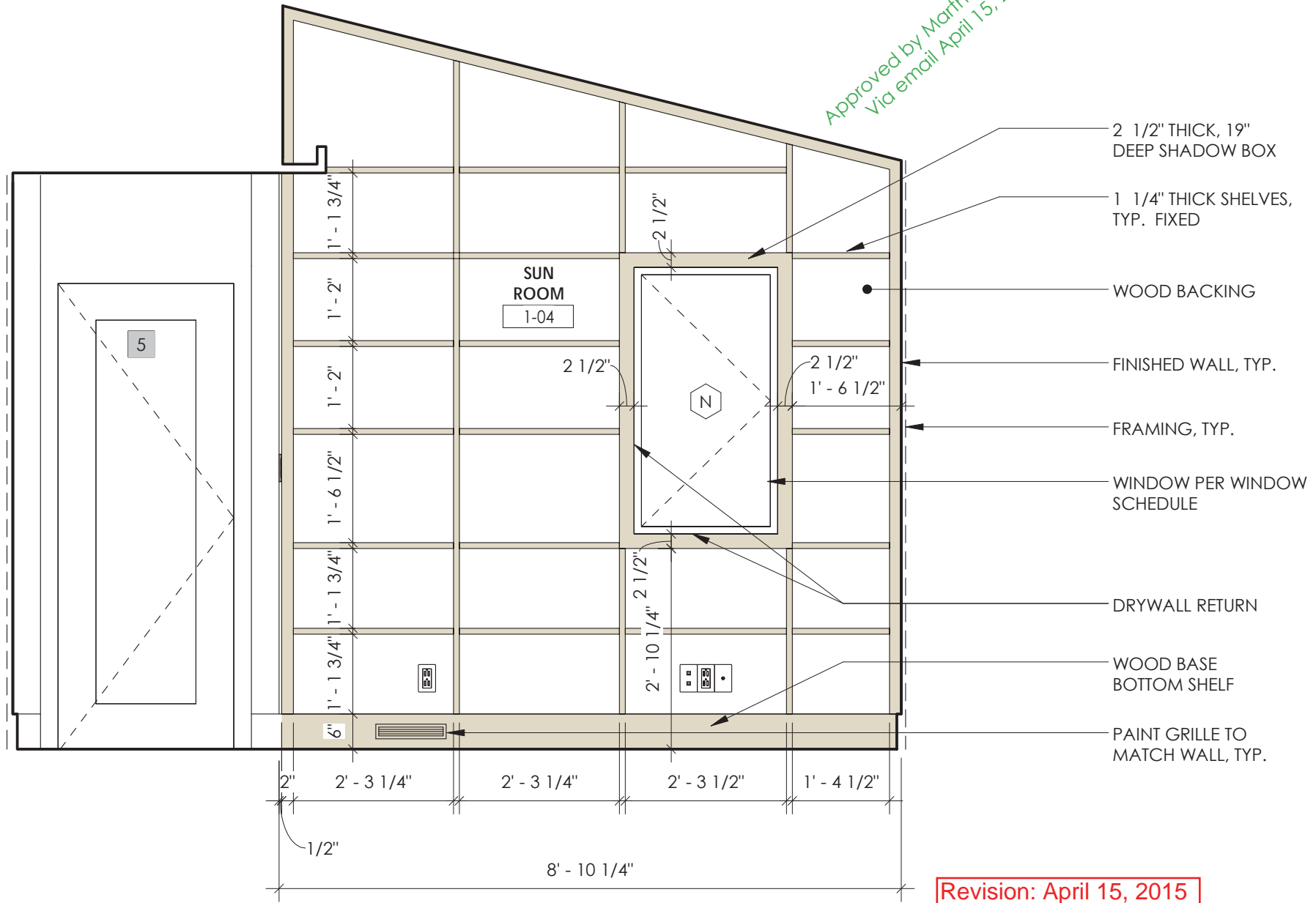

Revision: April 15, 2015

2 CABINERY PACKAGE - MAIN HOUSE - SUN ROOM - EAST ELEVATION  
1/2" = 1'-0"

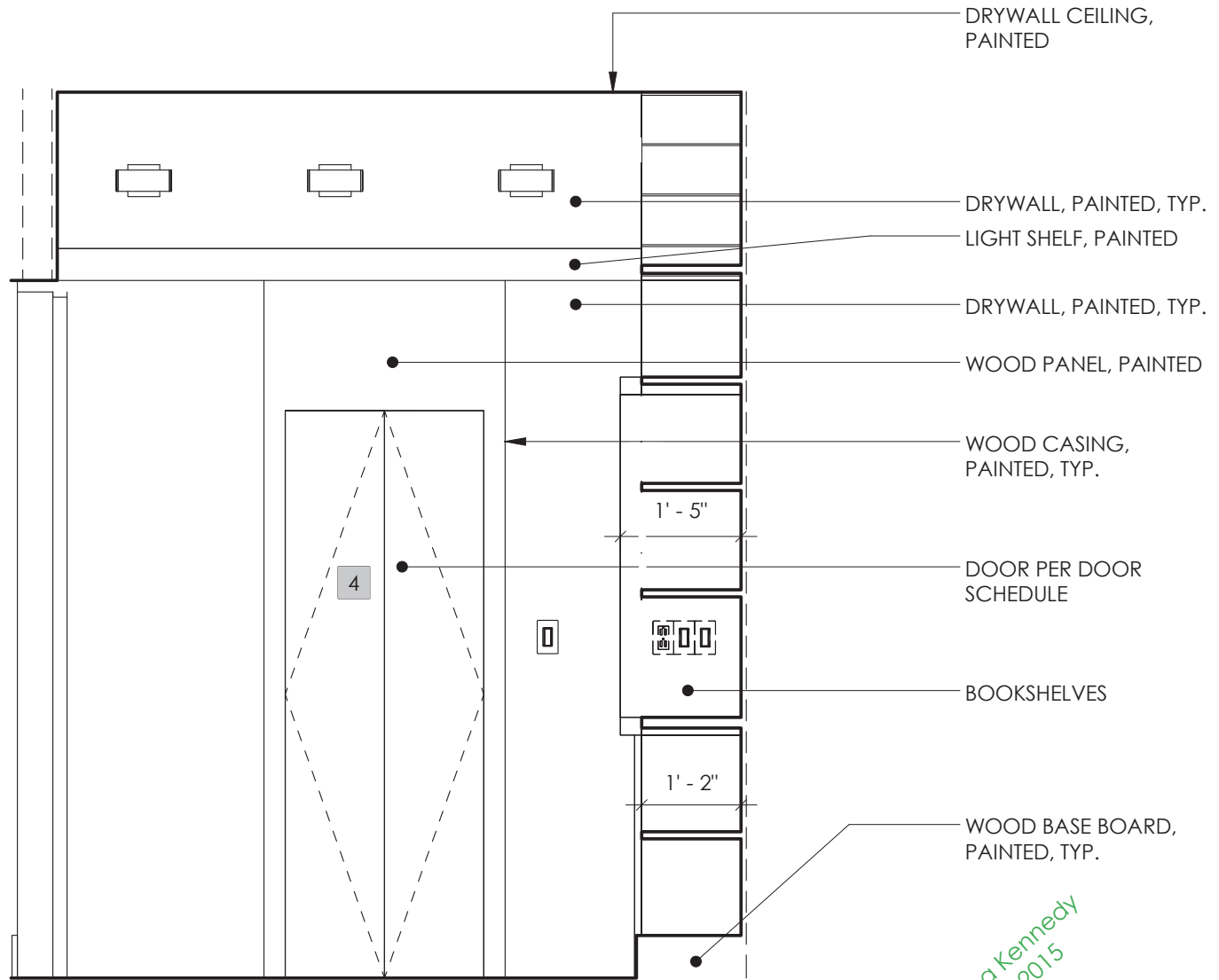

Approved by Martha Kennedy  
Via email April 15, 2015

Revision: April 15, 2015

1

CABINETRY PACKAGE - MAIN HOUSE - SUN ROOM - NORTH ELEVATION

1/2" = 1'-0"

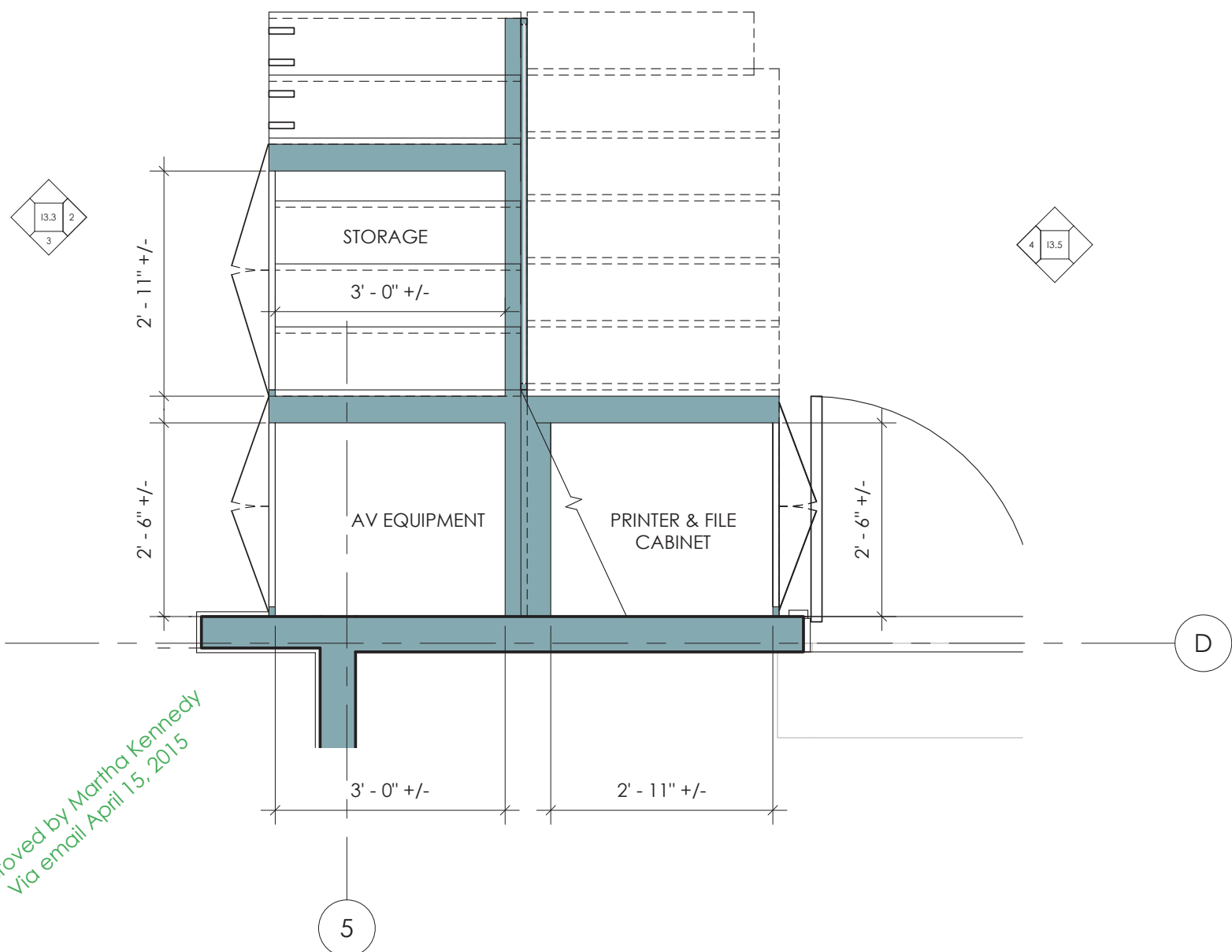

Approved by Martha Kennedy  
Via email April 15, 2015

Revision: April 15, 2015

Approved by Martha Kennedy  
Via email April 15, 2015

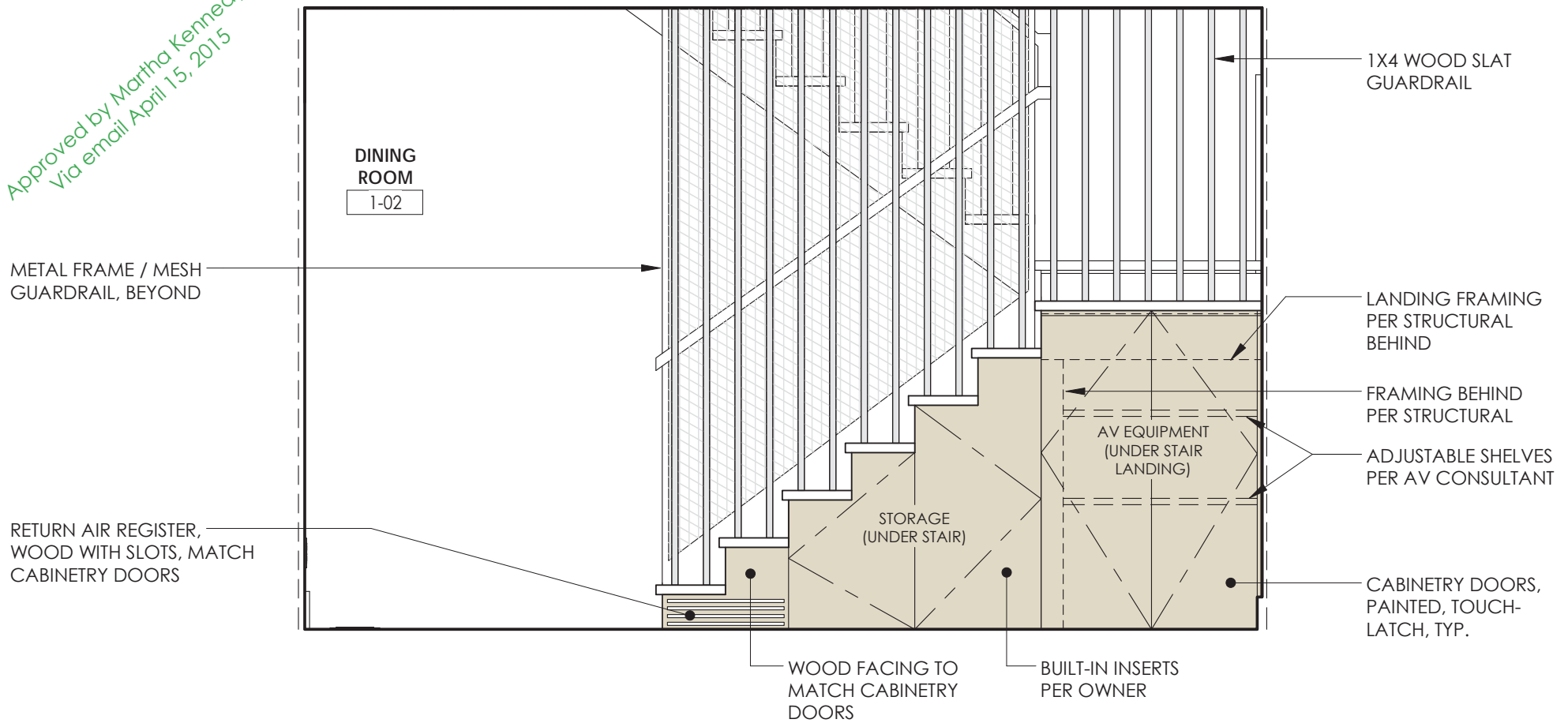

Revision: April 15, 2015

2

CABINETY PACKAGE - MAIN HOUSE - DINING ROOM - EAST ELEVATION

1/2" = 1'-0"



Approved by Martha Kennedy  
Via email April 15, 2015

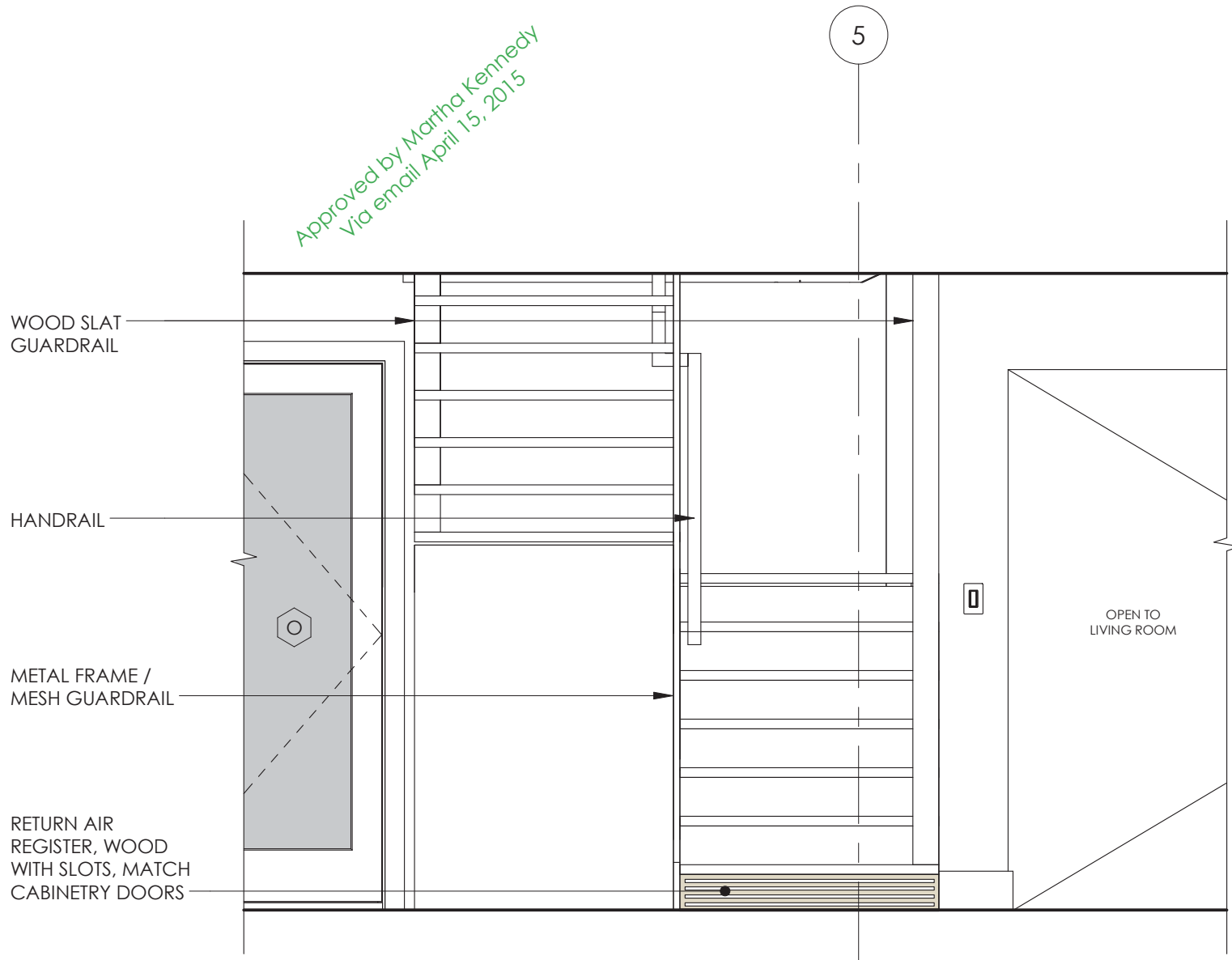

Revision: April 15, 2015

3

CABINERY PACKAGE - MAIN HOUSE - DINING ROOM - SOUTH ELEVATION

1/2" = 1'-0"

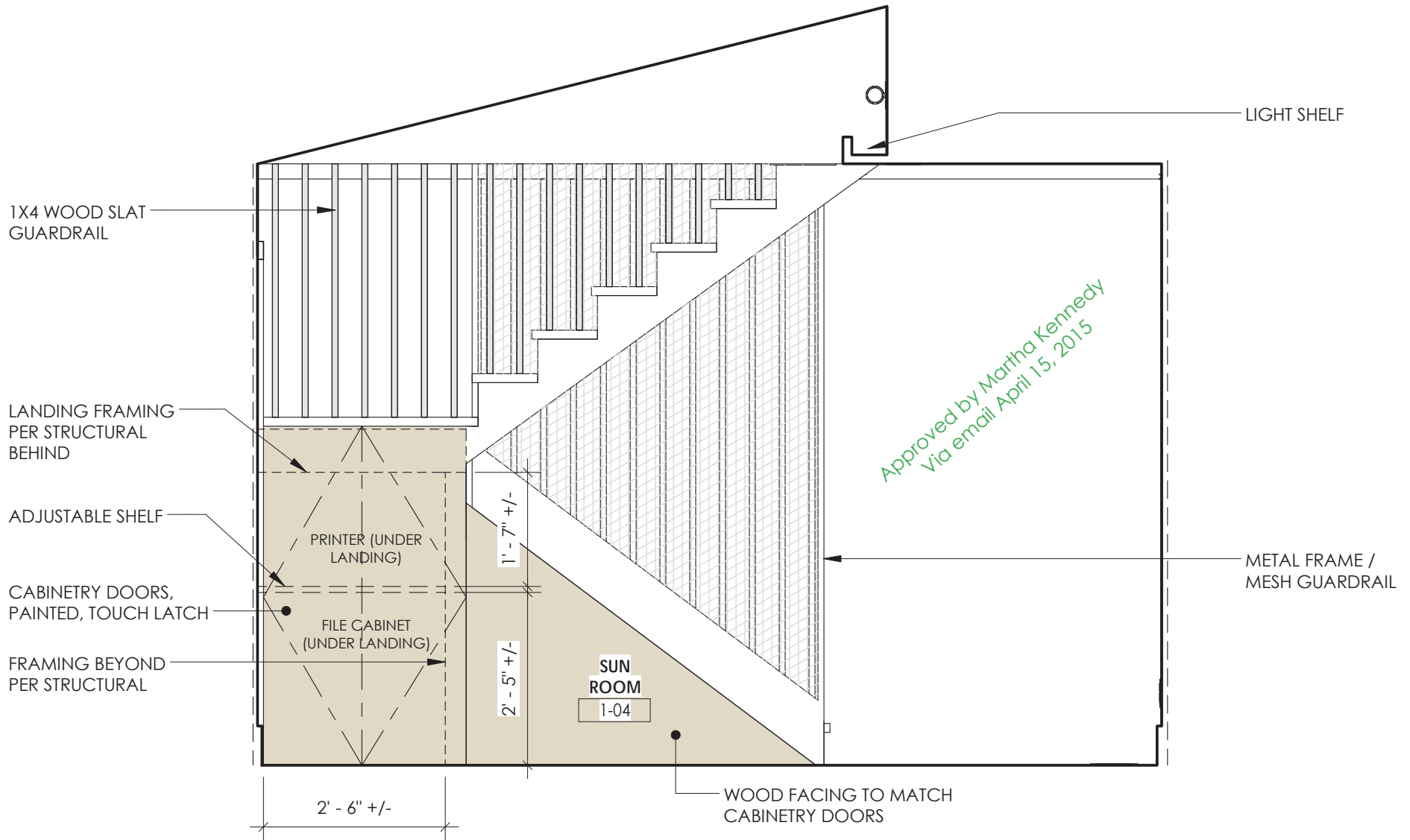

Revision: April 15, 2015

4 CABINETY PACKAGE - MAIN HOUSE - SUN ROOM - WEST ELEVATION

1/2" = 1'-0"